

Product Change Notification

Overview: Please be advised that the following is notice of change to Fire Research pressure sensors.

Products Affected: All pressure sensors used for intake and discharge pressure displays, portable testers, pressure governors, and tank indicators.

This includes the following FRC part numbers:

XE-IO3100PT2-S0A, XE-FP4000PT1-S0A, XE-PRO31PT2-S0A, XE-PRO1000PT1-S0A, XE-WLPT1-S0A, XE-WLPT10-S0A

Change Description: The above pressure sensors are being discontinued. New sensors will be direct replacements in all orders starting on or about 01APR06.

Reason For Change: Part of the ongoing process to improve FRC products.

Replacement Product: New pressure sensors will be direct replacements. They meet or exceed all electrical and mechanical requirements, use the same 3-Pin Packard connector and mount in a 1/4 inch NPT port.

Important Note: The new sensors all have the same dimensions and are slightly larger than the old ones. The difference may be as much as 0.4 inch depending on which old sensor it is compared to. Refer to the referenced drawing for complete dimensions of the new sensors.

The following are FRC part numbers for the new sensors:

XE-IO3100PT2-S0B, XE-FP4000PT1-S0B, XE-PRO31PT2-S0B, XE-PRO1000PT1-S0B, XE-WLPT1-S0B, XE-WLPT10-S0B

(Note: The only difference in the part number is the revision letter B at the end.)

References: The following drawing is available for the new pressure sensors:
DWG. NO. XE-XXPT1DWG-R0B dated 13JAN06

Response: No response to this notification is required. Requests for additional information should be directed to an FRC sales representative at 1.800.645.0074.

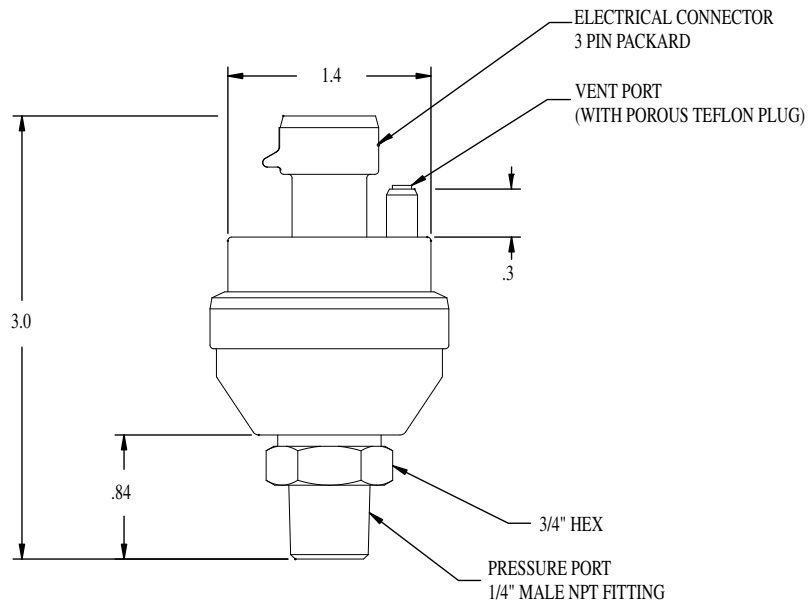
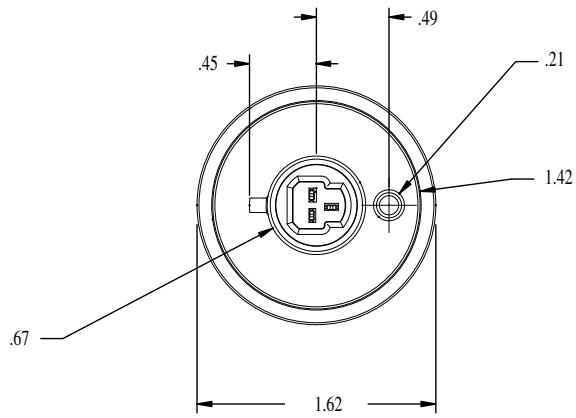

Dimensions are in inches.

This drawing is valid for pressure sensors with the following FRC part numbers:
 XE-IO3100PT2-S0B, XE-FP4000PT1-S0B, XE-PRO31PT2-S0B,
 XE-PRO1000PT1-S0B, XE-WLPT1-S0B, XE-WLPT10-S0B

Fire Research Corp.
 Drawing Number
 XE-XXPT1DWG.R0B
 Date 13JAN06